



5300 Series

Door furniture



The 5300 Series narrow stile furniture is designed for use in commercial applications, including exterior and interior doors for retail/shop front, educational, governmental, medical and public buildings. The narrow plate is ideal for use on narrow aluminium or timber stiles.

With a range of modern and contemporary lever designs, the 5300 Series will complement any décor. The handing mechanism of this Series allows the furniture to be handed on site, by simply rotation of the handle in the preferred direction of use prior to installing on the door.

Features

- Constructed of commercial grade quality components including forged brass handles and extruded brass plates
- Heavy duty compression spring provides a smooth, positive return action of the lever and eliminates droop, extending the life of the product
- Symmetrically designed levers are able to be handed on site within seconds, with a simple 180° rotation of the lever in the preferred direction of use prior to installation
- Designed for use with Legge 995 narrow stile mortice locks, the 5300 Series can also be supplied to suit Legge 990MF mortice locks
- The 30 year warranty provides specifiers and users with assured quality and performance

Specification guide

Function	Levers	Finish
refer following pages	refer following pages	Antique bronze A Chrome plate C Oil rubbed bronze ORB Polished brass P Polished brass unlacquered PU Satin chrome plate S Satin black chrome SBC Satin brass SB Satin brass unlacquered SBU

- 1. Function**
Select the desired function e.g. External plate with cylinder 5300/
- 2. Lever**
Select the required lever design - e.g. Donatello #54 5300/54
- 3. Finish**
Select the desired finish e.g. Satin chrome plate 5300/54S

Note: For furniture to suit 990MF locks add M to specification guide after function - applies to functions; External 00, 04, 10, 14, Internal 01, 03, 11, 13

Handing guide

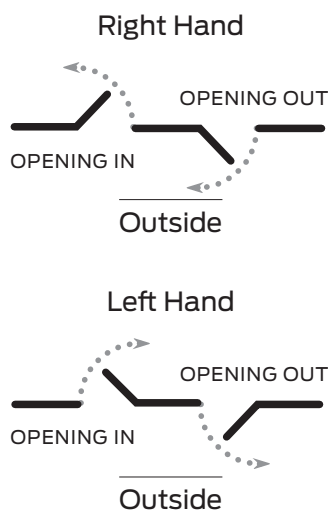

Specifications	
Door type	Timber or metal
Door thickness	32mm to 50mm
Spindle size	7.6mm
Compatible locks/ latches	Legge 995MF Series mortice locks Legge 990MF Series mortice locks for timber doors
Fixing centres	159mm
Fixing	Back to back, external plates concealed fixing, screws supplied with exterior plates only, screw length 75mm
Materials	Levers — forged & extruded brass Plate — extruded brass
Finishes	Antique bronze, Chrome plate, Oil rubbed bronze, Polished brass, Polish brass unlacquered, Satin chrome plate, Satin black chrome, Satin brass, and Satin brass unlacquered
Warranty	30 year mechanical 10 year finish for C, P, PU, S, SB and SBU 1 year finish A, ORB, and SBC

Lever handing

Handing is as simple as a turn of the handle.

The handing mechanism of the Legge 5300 Series eliminates the need to specify the handing of symmetrically designed levers. Handing of the lever is as simple as rotating the handle 180° as illustrated. This mechanism removes

the need to have stops and handing screws, thus saving time and money.

Note: For asymmetrically designed levers handing can not be reversed, and will require left or right handing to be specified when ordering.

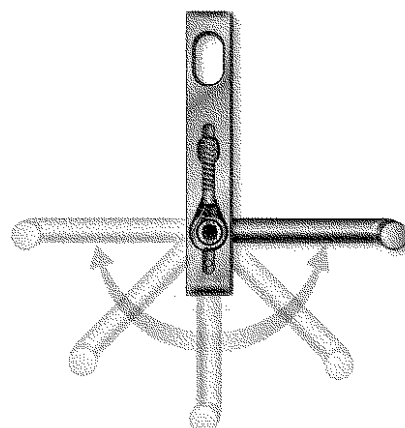

For 995MF Series mortice lock

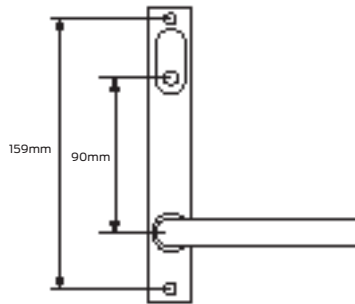

For 990MF Series mortice lock

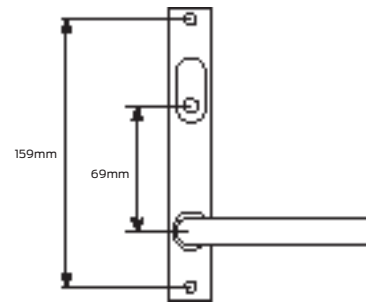

External plates

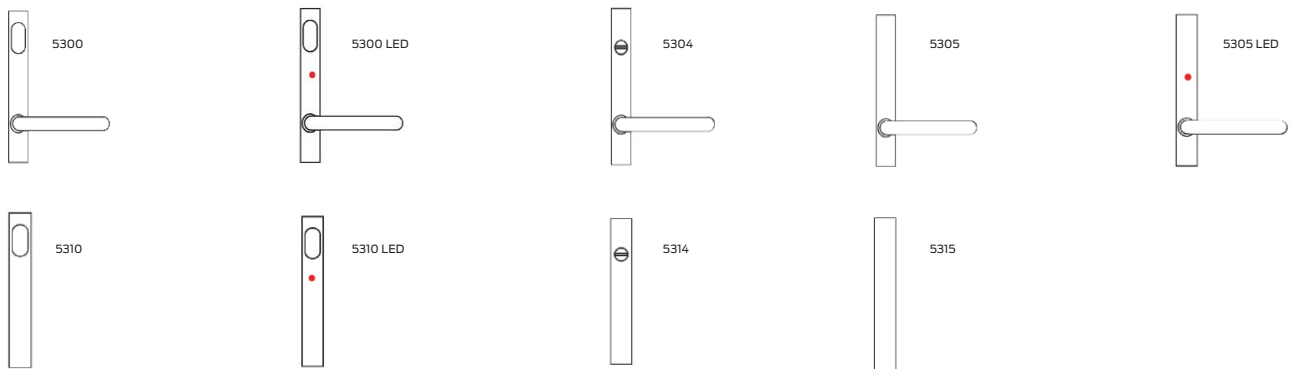

Internal plates

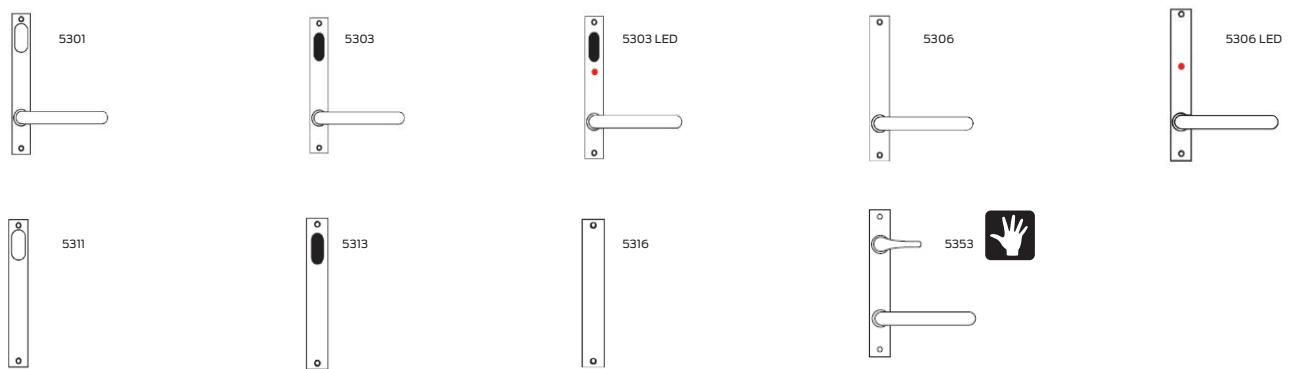

Depicted in RH

Legend

Turn snib



LED



Cylinder hole



Large turn



Emergency button



Accessible Turn



Denotes handed lever

Legge 5300 Series levers

Alessandro #55

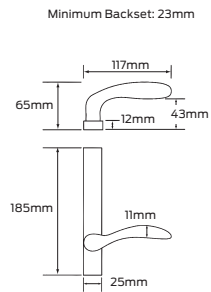

Alpha #29

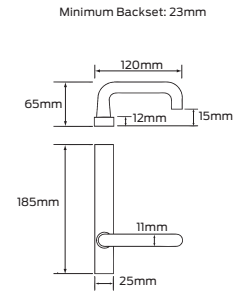

Angelo #57

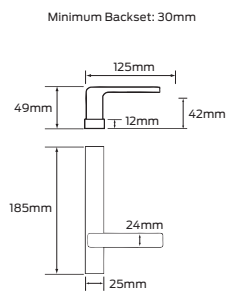

Bergen

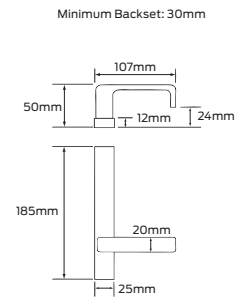

Chagall #51

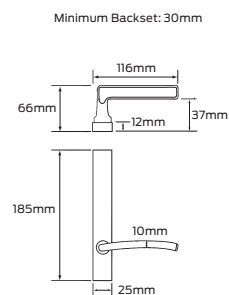

Cisa #59

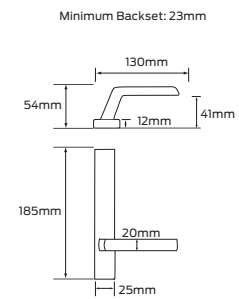

Legge 5300 Series levers

Diablo #15

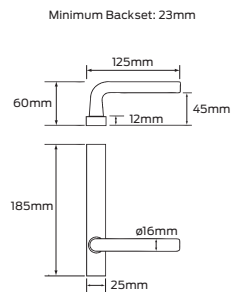

Ergo #62

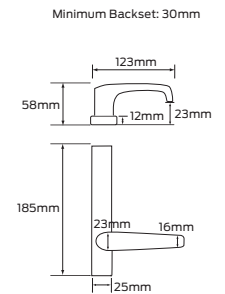

Leonardo #12

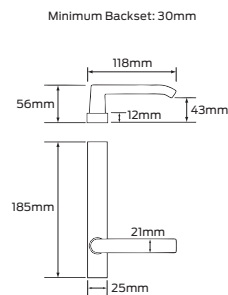

Monet #50

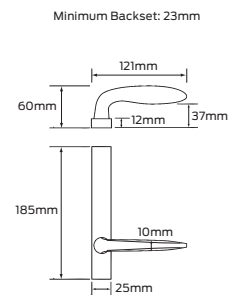

Neptune

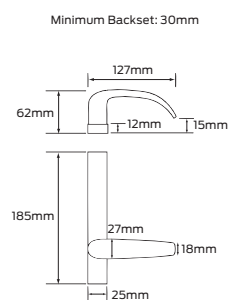

Renoir #52

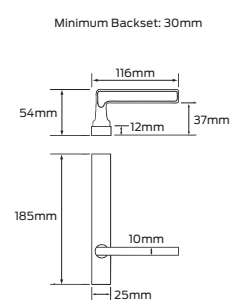

Legge 5300 Series levers

Rubens #56

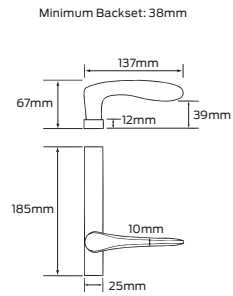

Salvador #27

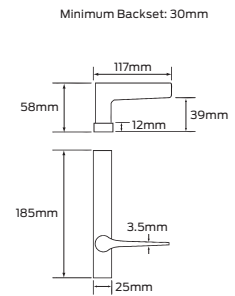

Trilo #61

